



Custom Valances - Special Designs

Conestoga offers a wide variety of arched panel configurations and options. Valances illustrated on the following pages represent popular custom arched panel designs. The manufacturing of custom valances is based off of customer-supplied dimensioned drawings. **If any of the following illustrations below match the look you desire, please copy the appropriate page, designate needed dimensions and fax to Customer Service.**

Arched panel valances are available in most mortise and tenon and miter designs. Applied moulding designs, while commonly available, depend on the radius of the panel. Cornwall, Cotswald, Newbury and Monaco designs are not available.

Design options include, but are not limited to all published panel raises and framing beads, edge profiles, grooved panels, wide framing, and custom rise dimensions.

A CAD drawing will be created prior to the manufacturing of any custom arched panel. After a review and sign off by the customer, the drawing must be faxed back to Special Designs in order for production to begin. Lead-time calculations will not begin until Conestoga has received an approved drawing.

Design Option A

- Framing widths will match door style selected unless otherwise noted by customer.
- Please provide appropriate sizes when ordering.

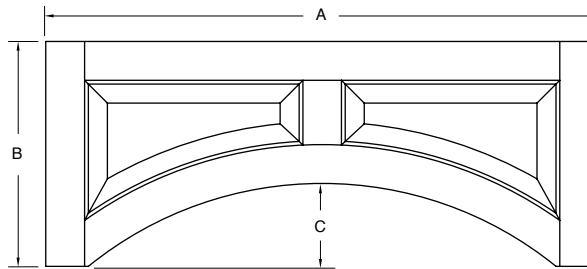

Sizes

A _____

B _____

C _____

Grain Direction

Vertical

Horizontal

Design Option B

- Framing widths will match door style selected unless otherwise noted by customer.
- Please provide appropriate sizes when ordering.

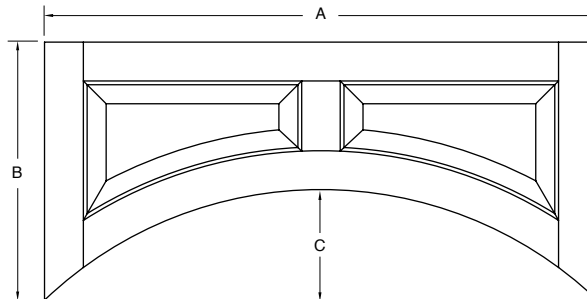

Sizes

A _____

B _____

C _____

Grain Direction

Vertical

Horizontal

Design Option C

- Framing widths will match door style selected unless otherwise noted by customer.
- Please provide appropriate sizes when ordering.

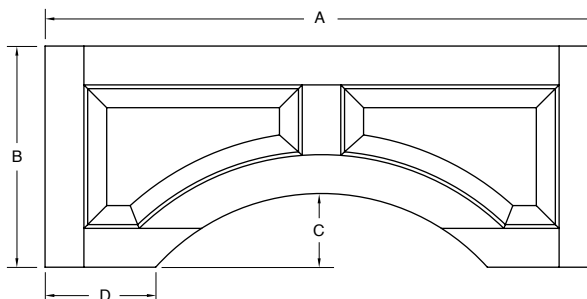

Sizes

A _____

B _____

C _____

D _____

Grain Direction

Vertical

Horizontal



Custom Valances - Special Designs (continued)

Design Option D

- Framing widths will match door style selected unless otherwise noted by customer.
- Please provide appropriate sizes when ordering.

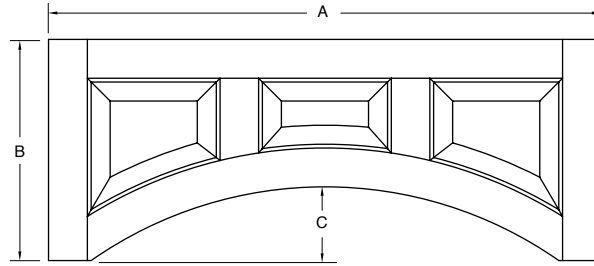

Sizes

A _____

B _____

C _____

Grain Direction

Vertical _____

Horizontal _____

Design Option E

- Framing widths will match door style selected unless otherwise noted by customer.
- Please provide appropriate sizes when ordering.
- Available with horizontal grain only.

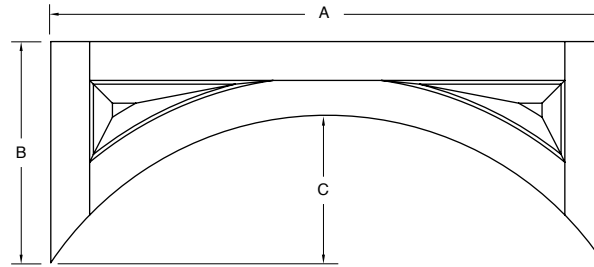

Sizes

A _____

B _____

C _____

Design Option F

- Framing widths will match door style selected unless otherwise noted by customer.
- Please provide appropriate sizes when ordering.

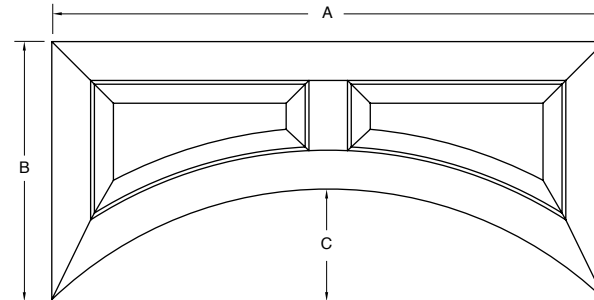

Sizes

A _____

B _____

C _____

Grain Direction

Vertical _____

Horizontal _____

Design Option G (applied moulding)

- Framing widths will match door style selected unless otherwise noted by customer.
- Please provide appropriate sizes when ordering.

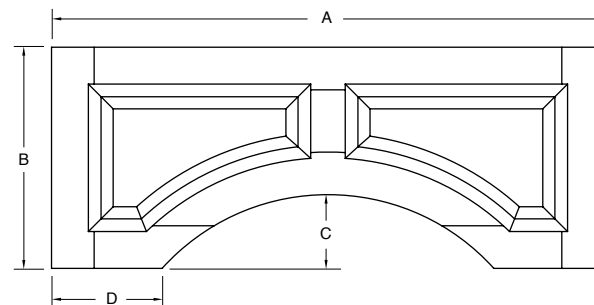

Sizes

A _____

B _____

C _____

D _____

Grain Direction

Vertical _____

Horizontal _____

Design Option H

- Framing widths will match door style selected unless otherwise noted by customer.
- Please provide appropriate sizes when ordering.

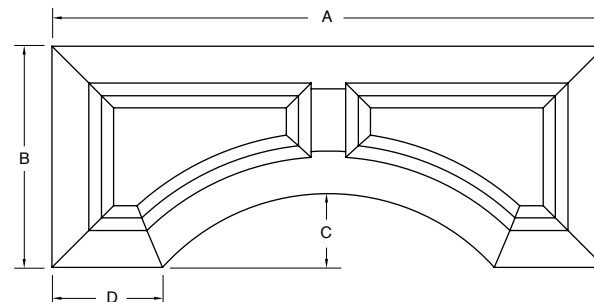

Sizes

A _____

B _____

C _____

D _____

Grain Direction

Vertical _____

Horizontal _____



Custom Valances

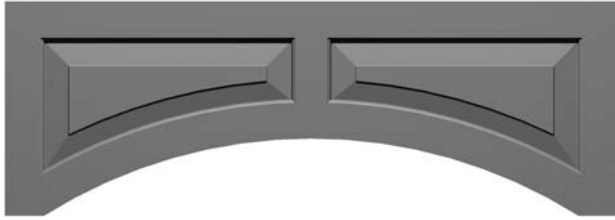

Arched Valance

Valances 30" to 48" – Design Charge \$140.00-B

Valances 51" to 72" – Design Charge \$165.00-B

Arched Raised Valance Offering and Availability

Arched Raised Panel Valances are available only in three inch wide increments from 30" to 72".

Minimum size is 30" wide x 12-1/2" high. Framing widths: 2-3/4" stiles, 2-5/16" rails, 2-1/2" upright mid-rail. The distance from the most narrow point to the widest point is always 4-1/2", regardless of valance width.

Horizontal grain panels are standard, vertical grain is available with a \$25.00 per valance upcharge.

Design standard as shown. Individual designs, including applied moulding, must be ordered through Special Designs.

Species

Material Pricing Guide All 3/4" and 1" species available, except 1" quarter sawn and rustic knotty species.

Edge Profiles

Page 5.1 Machine edge, no other choices available.

Framing Beads

Page 5.2 All 3/4" and 1" available.

Panel Raise

Page 5.2 All 3/4" and 1" raises available.

Options

Page 5.9-5.16 Pegs, distressing, cross grain sanding, radius corners, wear sanding, putty pin holes, cut down in width only.

Custom Valances (continued)

Valances are available in a 6" width only.

Valance pricing is determined using design plus material calculations. See the drawings below to determine appropriate design charge. Calculate overall square footage of valances and refer to category B of the specie desired in the Material Pricing Guide to determine material charge.



Classic Arch

Valances 21" to 60" – Design Charge \$25.00
Valances 60-1/16" to 96" – Design Charge \$30.00



Elegant Arch

Valances 21" to 60" – Design Charge \$25.00
Valances 60-1/16" to 96" – Design Charge \$30.00

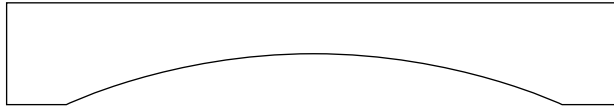

Roman Arch

Valances 12" to 60" – Design Charge \$20.00
Valances 60-1/16" to 96" – Design Charge \$25.00



Straight

Valances 12" to 60" – Design Charge \$6.30
Valances 60-1/16" to 96" – Design Charge \$14.30



Traditional Arch

Valances 16" to 60" – Design Charge \$20.00
Valances 60-1/16" to 96" – Design Charge \$25.00

Edge Profile Options

- Straight valance comes standard with machine edge, but is available with any edge profile. Specify which sides receive an edge profile.
- Roman Arch valance and Traditional Arch valance comes standard with machine edge. These valances are available with a variety of edge profiles; contact Special Designs for options and availability.
- Classic Arch valance and Elegant Arch valance are only available with a machine edge.

Valance Matrix Instructions

Use matrices on the following pages to determine the specifications for a patterned valance. Find the desired valance length in one of the C rows. The top number (white numbers in a black box) in the column with the desired length is the pattern length. The pattern will be centered on the valance.

From the C block containing the desired valance length, the extreme right number in that row, which is under column B, is the size of the non-patterned area on the left and right side of the pattern.

Example: If ordering a traditional valance with an overall length of 30" (dimension C), it can be seen that:

- 30" appears in the sixth C row, fourth column of the Matrix.
- Referring to the top of the column, in row A, a pattern length of 19" will be found.



Custom Valances (continued)

- Referring back to the 30" C row, at the right end of the row, in column B, a straight, non-patterned run of 5-1/2" on both the left and right ends of the valance will be found.
- The selected 30" valance will have a pattern 19" wide, centered on the valance, with 5-1/2" wide non-pattern areas at both ends of the valance.

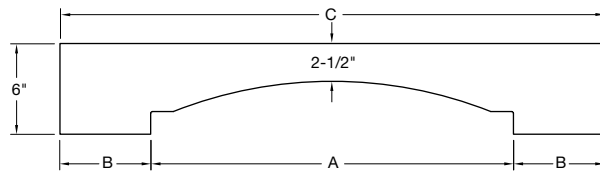

Classic Arch

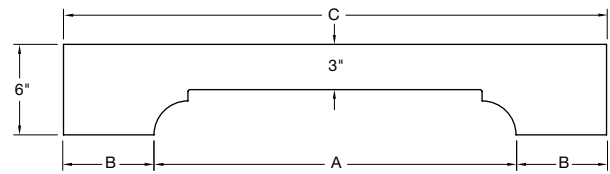

Elegant Arch

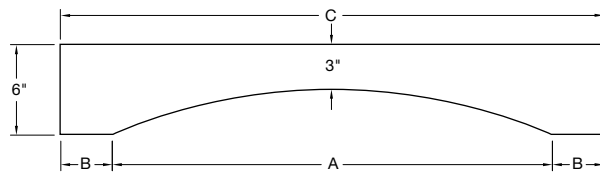

Roman Valance

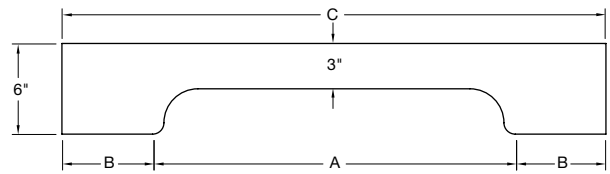

Traditional Arch

Valance Matrix											
A = Pattern length			B = Straight run on left and right ends					C = Overall length			
A	9"	11"	14"	19"	24"	30"	42"	54"	66"	78"	B
C	15"	17"									3"
C	16"	18"	21"	26"	31"	37"	49"	61"	73"	85"	3-1/2"
C		19"	22"	27"	32"	38"	50"	62"	74"	86"	4"
C		20"	23"	28"	33"	39"	51"	63"	75"	87"	4-1/2"
C			24"	29"	34"	40"	52"	64"	76"	88"	5"
C			25"	30"	35"	41"	53"	65"	77"	89"	5-1/2"
C					36"	42"	54"	66"	78"	90"	6"
C						43"	55"	67"	79"	91"	6-1/2"
C						44"	56"	68"	80"	92"	7"
C						45"	57"	69"	81"	93"	7-1/2"
C						46"	58"	70"	82"	94"	8"
C						47"	59"	71"	83"	95"	8-1/2"
C						48"	60"	72"	84"	96"	9"

Carved Valances

- Hand carved valance offering includes both Acanthus and Grape themed designs.
- Both the Acanthus and Grape designs feature a pierced (see-through) motif.
- 49" and 61" length fit multiple applications. The ends of the valance can be trimmed in the field to meet your particular sizing specifications.
- The width of all carved valances measures 6-1/2" from the top of the valance to bottom of carving.
- Because various manufacturing and sanding techniques are used to produce these decorative products, slight variations in the finished appearance may occur and will not be considered defects.
- Available in Cherry and Hard Maple only.
- Lead-time 10 days unfinished; add 5-6 days for finishing. Expedite lead-times are not available.

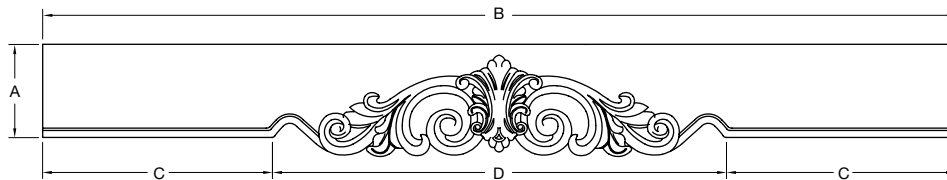

Carved Acanthus Valance

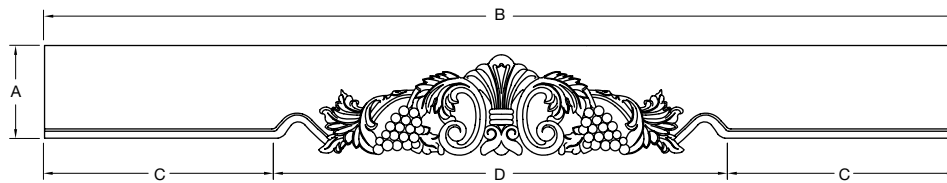

Carved Grape Valance

Carved Valance Pricing

Specie		Description	A	B	C	D	Price
Cherry	2651072A	Carved Acanthus Valance Pierced	5-1/2"	49"	11-1/2"	26"	\$190.00
Cherry	2651073A	Carved Grape Valance Pierced	5-1/2"	49"	12"	25"	200.00
Cherry	2651074A	Carved Acanthus Valance Pierced	5-1/2"	61"	15-1/2"	30"	215.00
Cherry	2651075A	Carved Grape Valance Pierced	5-1/2"	61"	16"	29"	225.00
Hard Maple	2651076A	Carved Acanthus Valance Pierced	5-1/2"	49"	11-1/2"	26"	170.00
Hard Maple	2651077A	Carved Grape Valance Pierced	5-1/2"	49"	12"	25"	180.00
Hard Maple	2651078A	Carved Acanthus Valance Pierced	5-1/2"	61"	15-1/2"	30"	195.00
Hard Maple	2651079A	Carved Grape Valance Pierced	5-1/2"	61"	16"	29"	205.00



Fluted Fillers

- Fluted fillers can be ordered in custom widths from 3" to 15-15/16" in all standard specie offerings including MDF.
- Choose from either Tapered or Rounded flutes. If not specified, flutes will be produced using the Tapered design.
- Non-fluted or "flat" areas are standard as shown, but can be customized to meet your design needs. Simply specify the flat dimensions desired. Specify "Flats to measure 0" to extend flutes the entire length of filler.
- Fluted filler pricing is determined using design plus material calculations. See the chart below to determine appropriate design charge. Calculate overall square footage of filler and refer to category B of the specie desired in the Material Pricing Guide to determine material charge.
- The number of flutes per filler width is indicated in the chart below. Custom flute spacing is available through Special Designs.

Fluted Filler Pricing			
Filler Width	No. of Flutes	Under 60" in length	60" or greater in length
3" to 3-15/16"	3	\$27.00	\$32.00
4" to 4-15/16"	4	27.00	32.00
5" to 5-15/16"	5	27.00	32.00
6" to 6-15/16"	6	32.00	37.00
7" to 7-15/16"	7	32.00	37.00
8" to 8-15/16"	9	32.00	37.00
9" to 9-15/16"	10	37.00	45.00
10" to 10-15/16"	11	37.00	45.00
11" to 11-15/16"	12	37.00	45.00
12" to 12-15/16"	14	45.00	52.00
13" to 13-15/16"	15	45.00	52.00
14" to 14-15/16"	16	52.00	62.00
15" to 15-15/16"	17	52.00	62.00

Edge Profile Options

- Fluted fillers come standard with a Machine Edge, but can be ordered with a variety of edge profiles including B-2, C-2, LC-2, L-059, L-061, L-149, PRS-2, V-2 and L-686.
- Beveled edge profile selections include the L-991 (45 degree back bevel) and the L-423 (22-1/2 degree back bevel).
- Premium edge profiles include the L-297, L-304 and LC-Inset edge. Upcharge applies.

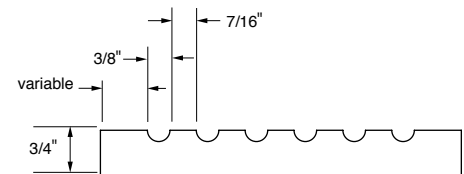
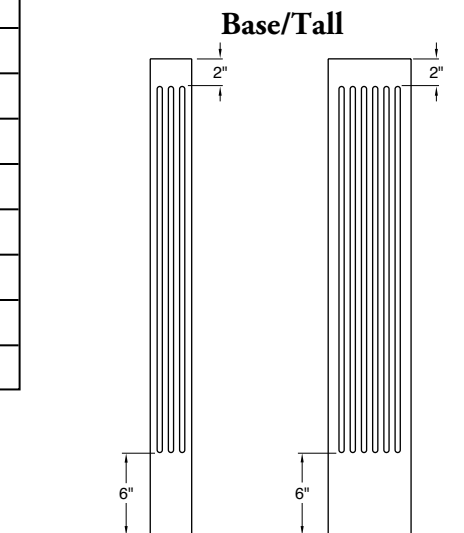
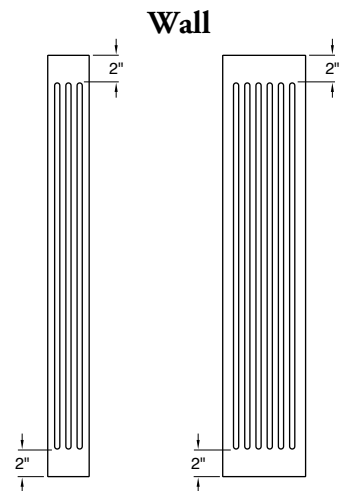
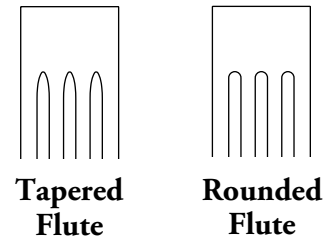

Section view

3" and 6" Fluted Fillers with Rosette

Fluted fillers with rosettes can be ordered in a tapered or rounded flute design. Flutes will be manufactured as "tapered flute" unless otherwise specified.

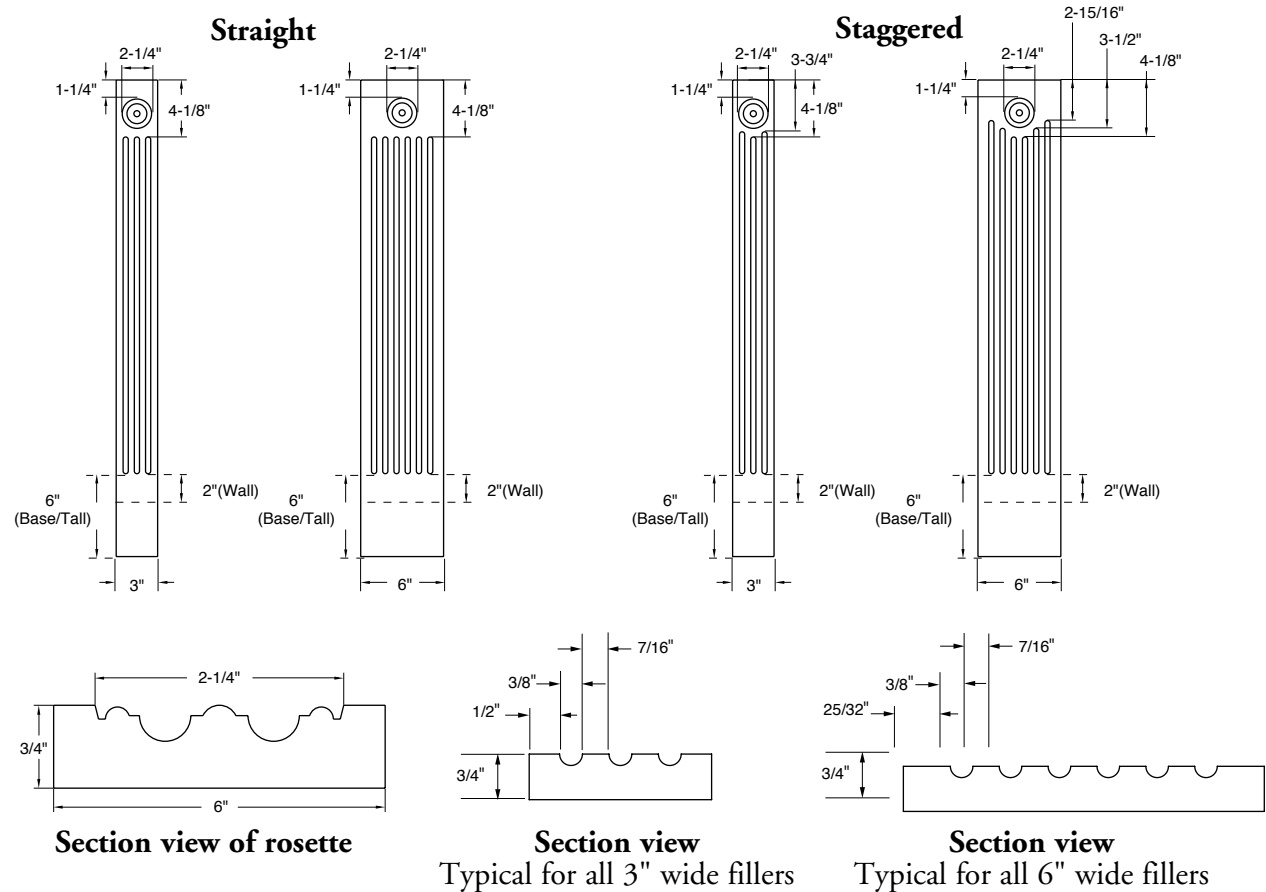

Fluted Filler with Rosette Pricing				
Description	3" Wide Fillers		6" Wide Fillers	
	Under 60" in Length	60" to 96" in Length	Under 60" in Length	60" to 96" in Length
Design Charge	\$30.00	\$35.00	\$35.00	\$40.00

Contact Special Designs for fluted filler with rosettes measuring over 96" in length.

- Fluted filler with rosette pricing is determined using design plus material calculations. See the chart above to determine appropriate design charge. Calculate overall square footage of filler and refer to category B of the specie desired in the Material Pricing Guide to determine material charge.
- Rosettes may be added to the bottom of these fillers for an additional \$2.00. The position of the bottom rosette will mirror the placement of the top rosette.
- Standard measurements for Wall and Base/Tall fluted fillers are identical with the exception of the length of the unfluted area on the bottom. Wall fillers are manufactured with a 2" unfluted area, Base/Tall fillers are manufactured with a 6" unfluted area.
- Flat dimensions (length of unfluted area) at ends of fillers are standard as shown. Specify custom flat dimensions if desired. Specify "Flats to measure 0" to order flutes extending the entire length of the filler on the bottom only. Top flat may not measure less than 3-3/8".
- Lead-time 10 days unfinished; add 5-6 days for finishing.



Front Frame Specifications

- Double dowel construction on standard width framing.
- Material will be standard grade unless premium is noted. Premium grade available, upcharges apply.
- Standard framing width is 1-1/2", additional widths available, upcharges apply.
- 3/4" framing thickness standard, 1" thick material is available, upcharges apply.
- Minimum framing width 3/4"; 15/16" for front frames with an edge profile.
- Material surfaced four sides.
- Assembled frames sanded on front only with 220 grit paper.
- Maximum front frame sizes are 96" in one direction and 48" in the other direction. For example, a front frame can be ordered 36" W x 96" H or 96" W x 36" H but not 96" W x 96" H.
- Framing wider than 4-1/2" may have one glue joint. Framing wider than 6-1/2" may have two glue joints.
- Minimum glue-in trimmable insert width is 1/2"; maximum glue-in trimmable insert width is 3".

Front Frame Tolerances

- A tolerance of +/- 1/32" is considered acceptable on front frame exterior and interior opening dimensions.
- A tolerance of +/- 1/32" out of square is considered acceptable on front frames under 12 square feet.
- A tolerance of +/- 1/16" out of square is considered acceptable on front frames 12 square feet and over.
- 1/32" offset on frame back at any joint is considered acceptable.
- 1/64" offset at any exterior joint on the outside perimeter is considered acceptable.

Front Frame Ordering Information

- Conestoga's custom front frames can be ordered as 1/4" beaded, 3/8" beaded or non-beaded. To specify, check the appropriate box in the beaded area of the order form.

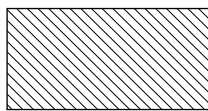

Non-beaded

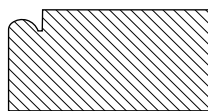

1/4" Bead

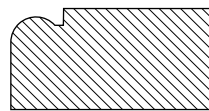

3/8" Bead

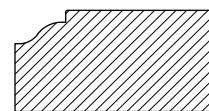

Ogee

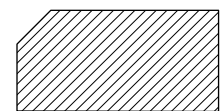

V-Bead

- Front frame exterior dimensions, interior opening dimensions and framing widths can be ordered to the nearest 1/16".
- On beaded orders, customers may select specific openings to be "non-beaded" by specifying the opening letter designation. Example: "Do not bead opening S."
- When ordering custom front frames for Conestoga Cabinet Systems, all framing and opening sizes must be specified by the customer. Only standard groove locations available.
- Contact your Customer Service or Sales Representative for front frame configuration templates. All front frames must be ordered using these templates.

Front Frame Pricing

Pricing Instructions

- Front frame pricing is based on the number of openings and the external frame perimeter.
- Use frame perimeter (lineal inches) x specie price per lineal inch. Use the appropriate column to determine the material price, based on specie and the number of openings.
- Add the appropriate cost per opening charges from the chart below.

Custom Front Frame Pricing				
Material Charge per Opening				
Specie	1 or 2	3 or 4	5 or 6	7 or 8
Alder	\$.17	\$.25	\$.28	\$.33
Bamboo	.27	.34	.43	.49
Birch, Red	.29	.36	.45	.52
Birch, White*	.17	.23	.29	.32
Cherry*	.24	.30	.37	.43
Hickory	.15	.22	.25	.29
Lyptus	.21	.28	.33	.38
Maple, Hard*	.17	.24	.29	.34
Maple, Soft	.15	.21	.25	.32
Oak, Red*	.14	.18	.21	.26
Oak, White*	.14	.19	.22	.27
Pine, Knotty	.16	.21	.25	.30
Walnut	.15	.20	.24	.28

*Indicates premium specie availability – upcharges apply.

Cost per Opening	
First opening	\$10.00
Additional openings, each	4.00

Options Pricing	
Option	Additional cost
Premium grade material (subject to availability)	35% of material price
1" thick framing*	30% of material price
Face and back sand	\$.75 per frame
Beaded inset framing (1/4" or 3/8" bead)	\$4.00 per opening
Ogee or V-bead framing	\$5.00 per opening
Pre-fit inset doors, drawer fronts	\$4.00 per door or drawer front
Groove to fit Conestoga Cabinet Systems	\$2.00 per frame
Edge profile around outside perimeter	\$5.00 per frame
Glue-in trimmable inserts	\$26.00 per opening
Cut Backs	\$30.00 per opening
Roman shaped rails - non-beaded	\$15.00 per rail
Beaded shaped rails available through Special Designs	Call for quote

*Bamboo is not available with 1" thick framing.

Pricing Methodology for Finished Custom Front Frames

- Front frame material charges are calculated using the perimeter of the front frame multiplied by 4, and then divide the result by 144. Multiply the result by the applicable material charge. Add the appropriate number of design charges based on the number of front frame openings.

Example: 2 opening front frame 30" x 36" in Harvest Gold

Pricing for all parts will be based on design + material methodology using material charges from Conestoga's finishing program (see section 6 for material and design charges).

Finished Custom Front Frames	
Number of openings	Design Charge Multiplier
1	1
2 to 3	1.5
4 to 5	2
6 to 7	2.5
8+	3

$$\left[\frac{(W+W+H+H) \times 4}{144} \times \text{Material Charge} \right] + \left[\frac{\text{Design Charge}}{\text{Multiplier}} \times \text{Design Charge} \right] = \left[\frac{(30+30+36+36) \times 4}{144} \times 3.40 \right] + \left[1.5 \times 7.75 \right] = 24.09$$



Front Frame Pricing (continued)

Non-standard Framing Width Pricing		Front Frames Lead-times			
Material Width	Upcharge per stile or rail	Product	Standard Lead-Time	Expedite max. 6 frames	
				Code Red	Code Blue
3/4" to 1-7/16"	\$7.50	Custom front frames	10-11	2	5
1-1/2"	no upcharge				
1-9/16" to 5-15/16"	6.00	Options, additional work days			
6" to 7-7/16"	12.00	Shaped rail	3	3	3
7-1/2" and wider	40.00	Pre-fit inset doors	2	2	2

Conestoga reserves the right to quote any odd configurations, odd framing widths or large volume orders on a per-job basis.

Orders containing products with different lead-times are given the lead-time date of the longest product.

Inset Door and Drawer Front Information

- The following edge profile options are recommended for use with inset doors and drawer fronts.
- These edges have a 5 degree back bevel edge to ensure sufficient door clearance. Machine edge is available upon request at no additional upcharge.

Standard Lip Options

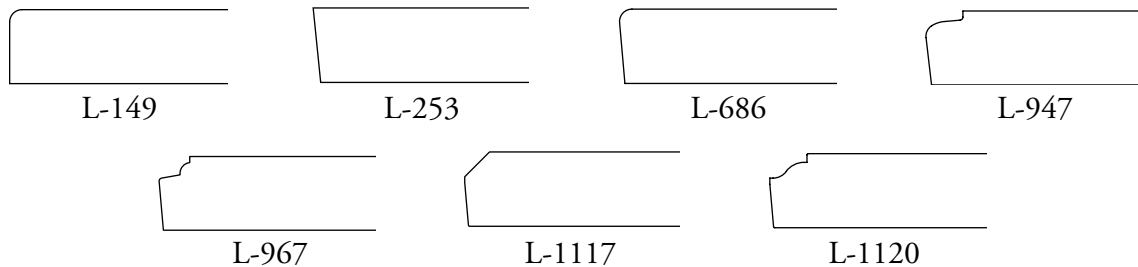

Premium Prefit/Inset Edge Profiles

\$14 additional charge per door.

These two profiles require 2 additional working days.

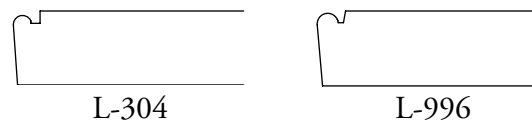

- Front frames ordered with inset doors and drawer fronts will be pre-fit to the opening size. A 3/32" margin will be used on all sides for single doors and drawer fronts and between butt door pairs.

Design Exceptions

- The following door and drawer front styles are not available for inset applications due to their unique design characteristics: Astoria, CRP-1420, CRP-10191, CRP-10318, CRP-10334, CRP-10827, CRP-10875, CRP-10946, DVG Batten, Fairhaven, Flush Batten, Gainsborough, LaSalle, Milan, Prestige, Royal, Savoy, TW-10318, TW-10827, 10946, V-200 and Windham.
 - * Recessed panel doors and drawer fronts in the above designs are not available for inset applications.
- The following edge profile options are not available for inset applications: B, B-2, C, C-2, CFP-2, E-2, FEP, FP, H, H-2, J-2, L-034, L-059, L-061, L-120, L-281, L-772, L-803, LC-2, PRS-2, RC-2 and V-2.
- Openings with trimmable inserts are not available beaded.
- Inset doors and drawer fronts are not available in MDF products.
- Finished front frames are not available with antiquing or wear sanding.
- Distressed front frames will receive a modified distressing package.



Inset Door and Drawer Front Information (continued)

- Custom front frames that are ordered with Colourtones and glazes will receive the same hand glazed finishes as doors. Cabinet Systems parts that are ordered with Colourtones and glazes will continue to be finished with the special Colourtones that have been tinted to match the Colourtones and glaze combination. They will not receive a hand rubbed glaze. Some options, such as Heirloom and Brushed glazes that are available on Custom front frames are not available on Cabinet Systems parts.

Miter/Inset Combination Not Recommended

Miter doors and drawer fronts are not recommended for inset applications for the following reasons:

- **Miter lines may not intersect door corner after pre-fit sanding.** Not considered a defect by Conestoga, this condition may not be visually pleasing to some customers.
- **Panel expansion caused by high humidity may cause miter doors to bind inside frame openings.** Although Conestoga's miter door joint construction is one of the industry's most durable, high humidity will cause panel expansion. The resulting pressure can push the mitered door framing outward against the frame openings.
- If a miter design is necessary, Conestoga recommends specifying a plywood or MDF center panel. See applicable specifications in the Custom Products Manual for further information.

1/8", 1/4", 1/4" Beaded and 3/4" Plywood Program

- 1/8" thick sheet stock with Grade A face veneer applied over plywood core with sound back.
- 1/4" thick sheet stock with Grade A face and back veneers applied over MDF core.
- 1/4" thick beaded sheet stock with Grade A face veneer applied over a MDF core with sound back. Groove spacing is 1-1/2" center to center and runs with the 96" direction. Grooves are 1/4" wide.
- Bead design on 1/4" beaded plywood panel does not match any CWS machined panel groove options.
- 3/4" thick sheet stock with Grade A face veneer applied over plywood core with prefinished natural Birch back, except where otherwise noted.
- 1/8", 1/4" and 3/4" sheet stock is available in full 4' x 8' sheets or as cut-to-size panels.
- Plywood finished in Colourtones may have pin marks and scratches from drying racks, veneer checks, seam separation, glaze smudges, fingerprints, overspray and some dirt in topcoat. Such defects will be kept to a minimum, but are unavoidable when finishing large parts and will not be considered defective. Edges will not be finished, unless edgbanding has been applied.
- Lead-time 4 days unfinished; add 5-6 days for finishing.
- Additional sheet stock is available through Special Designs in common species, grades and thickness in single sheet minimums. Specify thickness, core type, specie (face and back), veneer grade (face and back) and veneer cut (face and back). Lead-times and pricing are subject to availability.
- Oversized packaging charge of \$24.95 per item applies for large cut-to-size pieces or full 4' x 8' sheets of 1/4" or 3/4" material. Oversize packaging parameters and conditions apply when the size exceeds 35" wide and 35" long, the size exceeds 48" wide or 85" long, or a customer requests oversize packaging.



1/8", 1/4", 1/4" Beaded and 3/4" Plywood Program (continued)

Pricing Instructions

- Multiply actual square footage of panel by the appropriate specie material charge.
- Add the \$5.00 design charge and applicable options.

Options

- Cut-to-size charge: \$4.00 per panel.
 - ❖ When ordering cut-to-size plywood, specify width and height.
- Edgbanding Charges (3/4" plywood only):
 - ❖ .5mm wood banding 1 to 4 edges: \$8.75 per panel.
 - ❖ 3mm wood banding 1 to 4 edges: \$9.50 per panel.
 - ❖ For edgbanding on specific edges or cut-to-size plywood, specify edges as follows: top, bottom, left, right or all edges.
- Grooving available (1/4" material only).
 - ❖ G-012, G-015 or G-056 groove profiles.
 - ❖ Spacing available in 1/2" increments starting at 1/2" up to 4".
- Panel Grooving charges (per panel):
 - ❖ Up to 24" wide and 48" or under in length: \$8.00.
 - ❖ Up to 24" wide and over 48" in length: \$16.00.
 - ❖ Over 24" wide and 48" or under in length: \$16.00.
 - ❖ Over 24" wide and over 48" in length: \$32.00.
- Edgbanding and grooving options each add 1 additional day to the lead-time.
- Cut-to-size or full sheets of plywood are available unfinished or finished; see Solid Wood Finishing Program section for finish options and pricing.
- Colourtone finishes are available on Cherry, Hard Maple, White Birch and Red Oak plywood only.

1/8" Plywood Panel Program		
Specie	Material Charge	Design Charge
Cherry	\$4.50	\$5.00 (list) per panel
Hickory	4.25	
Maple, Hard	4.00	
Red Oak	3.75	

1/4" Plywood Panel Program		
Specie	Material Charge	Design Charge
Alder	\$4.50	\$5.00 (list) per panel
Birch, Red	5.10	
Birch, White	3.75	
Caramelized Bamboo	7.00	
Cherry	4.40	
Maple, Hard	4.25	
Hickory	4.25	
Knotty Pine	3.90	
Lyptus	5.40	
Quarter Sawn Red Oak	4.25	
Quarter Sawn White Oak	4.25	
Red Oak	3.60	
White Oak	4.00	
Walnut	5.35	

1/4" Beaded Plywood Panel Program		
Specie	Material Charge	Design Charge
Cherry	\$5.10	\$5.00 (list) per panel
Hickory	4.90	
Maple, Hard	4.90	
Red Oak	4.20	

3/4" Plywood Panel Program					
Specie (Face/Back)	Material Charge	Design Charge	Specie (Face/Back)	Material Charge	Design Charge
Alder/Natural Birch	\$6.00	\$5.00 (list) per panel	Maple, Hard/Maple, Hard	\$6.25	\$5.00 (list) per panel
Caramelized Bamboo/Bamboo* (MDF core)	13.50		Maple, Hard/Natural Birch	5.75	
Cherry/Cherry	6.50		Red Oak/Red Oak*	5.00	
Cherry/Natural Birch	5.90		Wenge/Wenge* (MDF core)	17.50	
Lyptus/Natural Birch	10.50		Zebrawood/Zebrawood* (MDF core)	17.50	

*Available with .5mm edgbanding only.



1/4" Short Grain Plywood Program

- 96" x 48" panel for island back or wall panel applications.
- Grain runs vertically in the 48" direction.
- 1/4" thick material with Grade A face veneers applied over MDF core with sound back.
- Available unfinished or finished; see Solid Wood Finishing Program section for finish options and pricing.
- Lead-time 3 days unfinished; add 5-6 days for finishing.
- Oversize packaging fee of \$24.95 applies.

1/4" x 96" x 48" Plywood Short Grain Panel	
Specie	Price
Cherry	\$158.00
Hickory	150.00
Maple, Hard	148.00
Red Oak	135.00

1/4" Solid Refacer's Program

- Solid 1/4" thick moulding is designed to be applied over the face frames of existing cabinetry in field refacing applications.
- Moulding 2073 is available in 1/16" width increments from 1" to 6" wide x 96" long.
- Variable width refacer's moulding is available in prime grade material. Sizes shown in the table below are for 1/4" thick "surfaced four sides" (S4S) square stock. Material moulded and sanded.
- Available finished or unfinished. If finish option is chosen, moulding will be finished on face and two edges only.

Ordering and Sizing Specifications

- Moulding is categorized and priced by width. Moulding width refers to the smallest whole-inch dimension of the refacing segment required. If the moulding is 1.01" wide, the appropriate pricing will be located in the 2" column. This rule is typical in all sizes.
- Moulding wider than 5-1/16" may have one glue joint running the entire length.

1/4" Thick Solid Refacing Moulding Pricing						
8' Choice Grade 7-12 day lead-time						
Specie	Moulding Width					
	1"	2"	3"	4"	5"	6"
Alder	\$11.50	\$16.10	\$19.00	\$23.00	\$27.00	\$30.25
Bamboo	17.25	26.50	32.00	39.75	48.00	54.00
Cherry	15.00	22.50	24.50	29.75	35.75	40.25
Hard Maple	13.50	18.00	20.75	24.00	27.50	30.50
Lyptus	13.50	18.00	20.75	24.50	28.00	31.50
Paint Grade	9.00	11.00	12.00	13.75	15.25	16.50
Pecan Hickory	9.50	11.75	13.00	15.00	17.00	18.50
Pine	11.00	15.00	17.50	20.75	24.50	27.25
Red Birch	15.00	23.50	28.00	35.00	43.00	48.50
Red Oak	9.75	12.75	14.50	16.75	19.25	21.25
Soft Maple	11.50	14.25	16.50	19.50	23.00	25.75
Walnut	13.75	20.75	25.25	31.50	38.00	43.00
White Birch	13.00	17.25	20.50	25.25	30.25	33.75

SPECIALTY PRODUCTS

Custom Products



Veneers

- All veneers are approximately 1/32" thick and have real wood faces.
- One end and one side of any veneer sheet is guaranteed to be free from physical damage.
- Wood back veneers have a cross grain wood backer which allows trim edges to be stained and finished to reduce "black line" effect.
- Poly back veneers are applied to a polymer resin impregnated membrane. They contain no added urea formaldehyde (NAUF), are rigid yet pliable and provide excellent moisture resistance.
- Wood back and poly back veneers are available with their applicable backer or a pressure sensitive adhesive (PSA). PSA veneers have a pre-glued adhesive layer protected by a peel coat covering that must be removed prior to application.
- Veneers are not guaranteed to perfectly match solid wood doors. Veneer is sliced from premium material; color and grain match will be more uniform than solid wood doors. Hickory veneers may contain mineral streaks and peck marks.
- Proper surface conditions and preparation is essential to successful application and performance of veneered surfaces.
 - ❖ Per manufacturer's recommendations, veneers of all backer types should be placed flat and allowed to acclimate 48 hours before installation.
 - ❖ Pressure sensitive veneers should not be applied to bare wood or surfaces covered with sanding sealers, high pressure laminates, melamine or other plastic materials.
 - ❖ Wood back and poly back veneers are best applied with roller grade adhesives. Sufficient adhesive coverage on both the veneer and substrate surface will ensure proper adhesion and performance.
- Conestoga is not liable for product failure due to improper surface preparation, adhesive selection or installation technique.
- Finishing option available. Stained veneers may vary slightly in color from solid wood products of the same specie. Finishing adds 5-6 days to standard lead-time.
- Conestoga does not accept returns on veneers.

PSA Wood Back

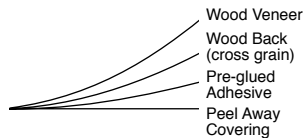

PSA Poly Back

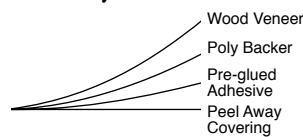

Wood Back

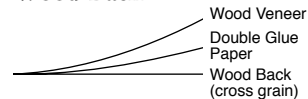

Poly Back

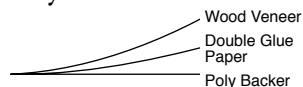

Specie	24" x 96"		48-1/2" x 97"	
	PSA Wood Back	PSA Poly Back	Wood* Back	Poly Back
Alder	\$92.00	\$92.00	\$125.00	\$125.00
Anigre	N/A	N/A	310.00	310.00
Bamboo	111.75	111.75	170.00	170.00
Birch, Red	98.00	98.00	141.00	141.00
Birch, White	75.00*	75.00	93.00*	93.00
Birdseye Maple	N/A	N/A	500.00	500.00
Cherry	78.00*	78.00	98.00*	98.00
Hickory	82.00	82.00	106.00	106.00
Lyptus	94.00	94.00	130.00	130.00
Macassar Ebony	N/A	N/A	225.00	225.00
Maple, Hard	75.00*	75.00	92.00**	92.00
Oak, Red	72.00*	72.00	85.00*	85.00
Oak, White	82.00	82.00	106.00	106.00
Pine, Knotty	88.00	88.00	119.00	119.00
Quarter Sawn White Oak	85.00	85.00	114.00	114.00
Walnut	92.00	92.00	127.00	127.00
Wenge	N/A	N/A	175.00	175.00
Zebrawood	N/A	N/A	175.00	175.00

Stock item 3 day lead time.

Custom item 10 day lead time.

*Available with Colourtone finishes.

+When ordered with Colourtone finishes, phenolic back veneers will be substituted.

Wood Edgebanding Program

Conestoga offers 500' rolls of .5mm wood edgebanding to complete your panel processing requirements.

- Real wood veneer applied to an unglued fleece backer.
- Edgebanding is not guaranteed to perfectly match solid wood doors or sheet stock. Veneer edgebanding is sliced from premium material; color and grain match will be more uniform than solid wood doors.
- Edgebanding will contain multiple splice joints which will not be considered a defect.
- Conestoga is not liable for product failure due to improper surface preparation, adhesive selection or installation technique.
- All Conestoga finishing options are available as outlined in the Solid Wood Finishing Program section of this manual.
- Lead-time 10 days unfinished; add 5-6 days for finishing. Expedite lead-times not available.
- Conestoga does not accept returns of finished edgebanding.

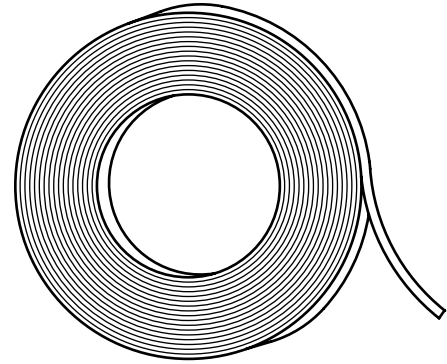

Wood Edgebanding

Specie	500' Rolls Price per roll (unfinished)	Specie	500' Rolls Price per roll (unfinished)
Alder	\$65.00	Macassar Ebony	\$185.00
Anigre	400.00	Pine	85.00
Bamboo	135.00	Red Oak	50.00
Birdseye Maple	200.00	Walnut	75.00
Cherry	65.00	Wenge	185.00
Hard Maple	50.00	White Birch	60.00
Hickory	65.00	White Oak	60.00
Lyptus	95.00	Zebrawood	185.00



Entry Level Range Hoods

- Conestoga's entry level range hoods are fully assembled and constructed of solid hardwood and plywood.
- 3/4" thick solid wood sides.
- Lower mantle area measures 4-1/4" between mouldings and will accommodate many wood ornaments, appliques and decorative tile.
- Includes epoxy coated metal liner. Ventilation unit not included.
- Metal liner accommodates Fujioh ventilation systems. For information and to receive special Conestoga program pricing, contact Stanisci Design: (586)752-3368.
- Beaded hood has 5/16" wide beading, spaced 1-1/2" on center.
- Available unfinished or finished; see Solid Wood Finishing Program section for finish options and pricing.
- Lead-time 4 days unfinished; add 5-6 days for finishing.

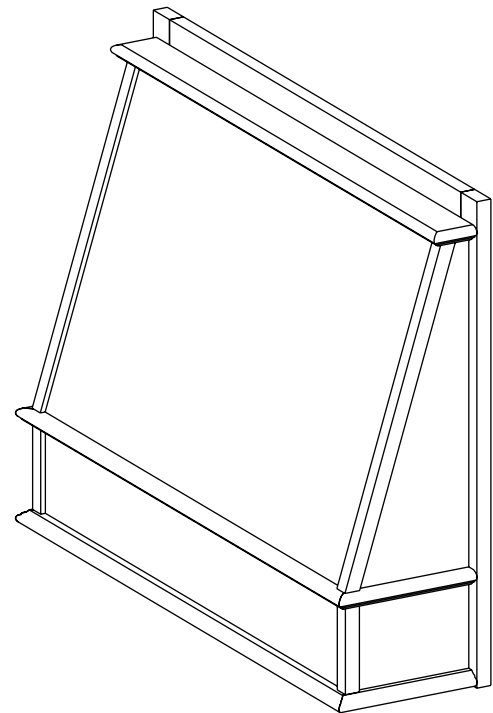

Standard Hood

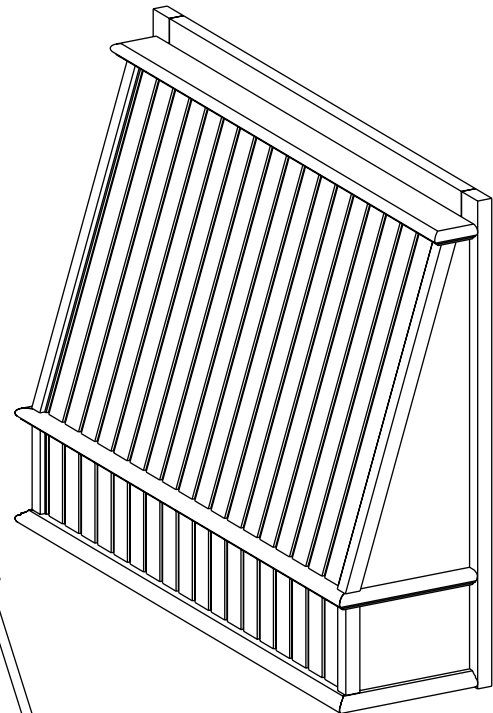

Beaded Hood

Specie	Unfinished Price	
	30"	36"
Standard Hood		
Cherry	\$350.00	\$375.00
Hard Maple	340.00	360.00
Hickory	350.00	375.00
Red Oak	325.00	345.00
Beaded Hood		
Cherry	\$370.00	\$395.00
Hard Maple	360.00	380.00
Hickory	370.00	395.00
Red Oak	345.00	365.00

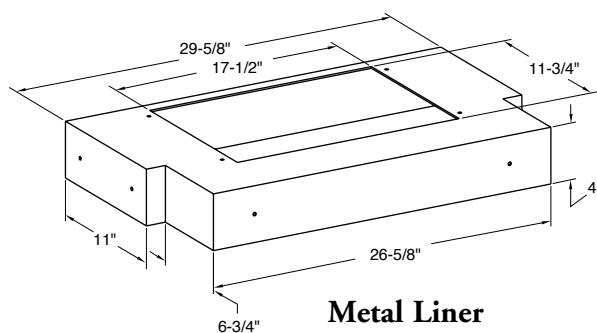

Metal Liner

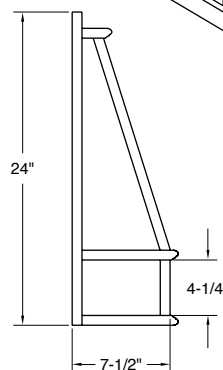

Side View



Stanisci Design Range Hoods

- Stanisci Design is a leading range hood manufacturer for the custom kitchen industry. This program allows for convenient ordering of custom range hoods and ventilation units. Conestoga's published offering includes several popular hood designs with panel raise and bead options. The selection of plywood and raised panel hoods is available in a wide variety of heights and widths. Custom sizing also available.

Program Details

- Range hoods are available unfinished or finished; see Solid Wood Finishing Program section for finish options and pricing.
- Pre-finished hoods will ship from Conestoga's Kenly, N.C. facility.
- Custom sizes, species and designs are available. Contact Special Designs for a quote.

Examples of custom designs:

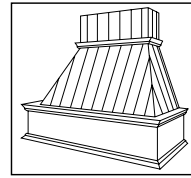

Hood shown with bead board option

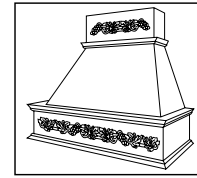

Hood shown with decorative moulding

- Liners are not included with hood unless otherwise noted. Ventilation units and stainless steel liners are available from Stanisci Design with discounted Conestoga program pricing. Contact Stanisci Design at (586) 752-3368.
- Recommended ventilator: Stainless steel units from 350 to 1500 CFM are available through Stanisci Design (586) 752-3368.
- Stanisci hoods are available in catalog format, compatible with 20-20 Design software. Contact your Sales Representative for information.

PLEASE NOTE: All Stanisci Range Hoods should be mounted no closer than 30" above cook tops.

Removable Panel Option

- Available on G, GRA, JRA, T, TRA and I-Series hoods.
- Allows for easy installation and access by building inspectors.
- Panel features applied moulding for finished look after installation.
- No additional lead-time required.
- When ordering specify the hood design then "Removable Panel Option".

Pricing: G, GRA, JRA, T, TRA - \$150
I-Series Hoods - \$280

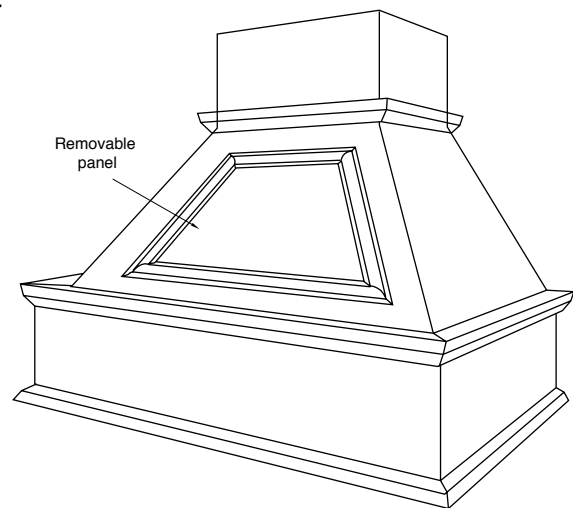



Stanisci Design Range Hoods – G-Series

G-Standard Hood

- G-Series is designed to best fit 8 foot ceilings.
- Removable chimney may be trimmed to desired height.
- Lead-time 12 days unfinished, add 5-6 days for finishing.
- Fixed panel standard - available with removable panel option.
- **Custom sizes available through Special Designs.**

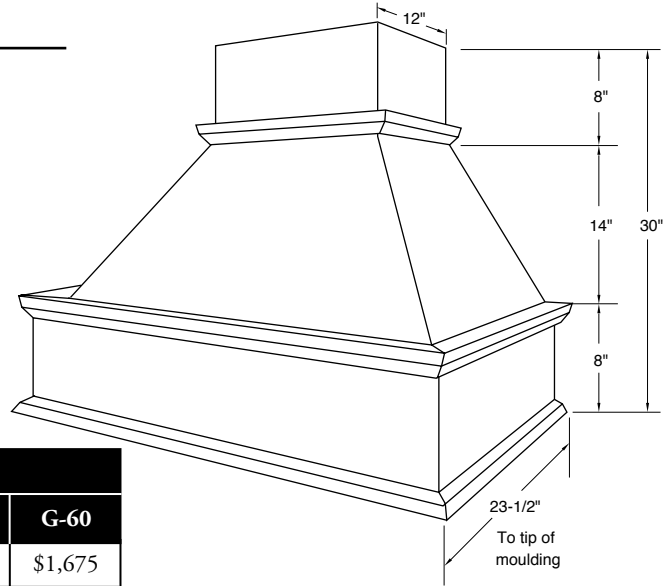

Specie	Part Number				
	G-36	G-42	G-48	G-54	G-60
Alder	\$1,150	\$1,175	\$1,200	\$1,625	\$1,675
Cherry	1,100	1,125	1,150	1,500	1,600
Hard Maple	1,000	1,025	1,050	1,425	1,475
Red Oak	950	975	1,000	1,350	1,400

Add 2-1/4" to width listed in pricing chart for actual overall width including trim moulding.

G-Raised Arch

- G-Raised Arch Series is designed to best fit 8 foot ceilings.
- Profile options - Framing Bead: Regular, Ogee or Square.
Panel Raise: Slant, G-Cove, RM, M-Bead or P-057.
- Removable chimney may be trimmed to desired height.
- Lead-time 17 days unfinished, add 5-6 days for finishing.
- Fixed panel standard - available with removable panel option.
- **Custom sizes available through Special Designs.**

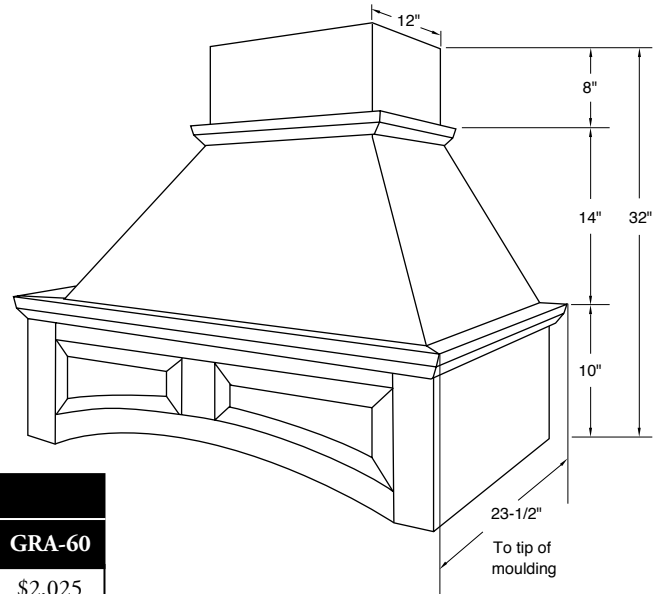

Specie	Part Number				
	GRA-36	GRA-42	GRA-48	GRA-54	GRA-60
Alder	\$1,385	\$1,425	\$1,490	\$1,950	\$2,025
Cherry	1,350	1,390	1,430	1,900	1,975
Hard Maple	1,250	1,290	1,330	1,775	1,825
Red Oak	1,200	1,240	1,280	1,700	1,750

Add 2-1/4" to width listed in pricing chart for actual overall width including trim moulding.



Stanisci Design Range Hoods – T-Series

T-Standard Hood

- T-Series is designed to best fit 9 foot ceilings and taller.
- Removable chimney may be trimmed to desired height.
- Lead-time 12 days unfinished, add 5-6 days for finishing.
- Fixed panel standard - available with removable panel option.
- **Custom sizes available through Special Designs.**

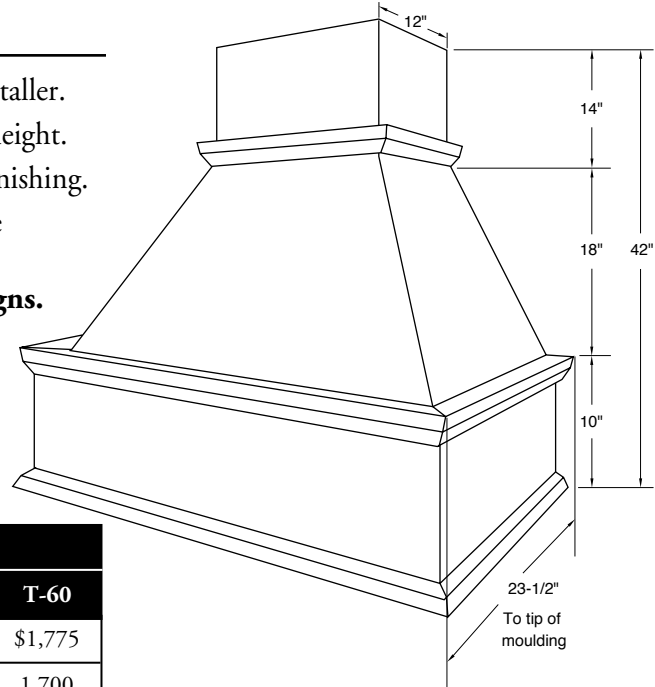

Specie	Part Number				
	T-36	T-42	T-48	T-54	T-60
Alder	\$1,250	\$1,275	\$1,300	\$1,725	\$1,775
Cherry	1,200	1,225	1,250	1,600	1,700
Hard Maple	1,100	1,125	1,150	1,525	1,575
Red Oak	1,050	1,075	1,100	1,450	1,500

Add 2-1/4" to width listed in pricing chart for actual overall width including trim moulding.

T-Raised Arch

- T-Raised Arch Series is designed to best fit 9 foot ceilings and taller.
- Profile options - Framing Bead: Regular, Ogee or Square.
Panel Raise: Slant, G-Cove, RM, M-Bead or P-057.
- Removable chimney may be trimmed to desired height.
- Lead-time 17 days unfinished, add 5-6 days for finishing.
- Fixed panel standard - available with removable panel option.
- **Custom sizes available through Special Designs.**

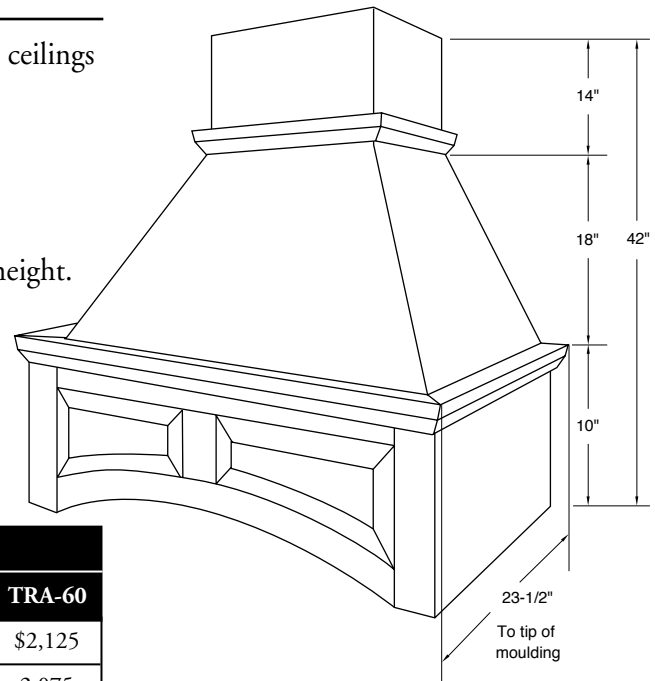

Specie	Part Number				
	TRA-36	TRA-42	TRA-48	TRA-54	TRA-60
Alder	\$1,485	\$1,525	\$1,590	\$2,050	\$2,125
Cherry	1,450	1,490	1,530	2,000	2,075
Hard Maple	1,350	1,390	1,430	1,875	1,925
Red Oak	1,300	1,340	1,380	1,800	1,850

Add 2-1/4" to width listed in pricing chart for actual overall width including trim moulding.

SPECIALTY PRODUCTS

Custom Products



Stanisci Design Range Hoods (continued)

E-Standard Hood

- E-Series can be sized to fit 8 or 9 foot ceilings.
- Lead-time 17 days unfinished, add 5-6 days for finishing.
- E-Series hoods are not trimmable. Specific heights available through Special Designs.
- Fixed panel standard - removable panel not available.
- **Custom sizes available through Special Designs.**

Specie	Part Number		
	E-36x30	E-42x30	E-48x30
Alder	\$3,750	\$3,850	\$3,950
Cherry	3,750	3,850	3,950
Hard Maple	3,650	3,750	3,850
Red Oak	3,600	3,700	3,800
Specie	E-36x42	E-42x42	E-48x42
Alder	\$3,850	\$3,950	\$4,050
Cherry	3,850	3,950	4,050
Hard Maple	3,750	3,850	3,950
Red Oak	3,700	3,800	3,900

Add 2-1/4" to width listed in pricing chart for actual overall width including trim moulding.

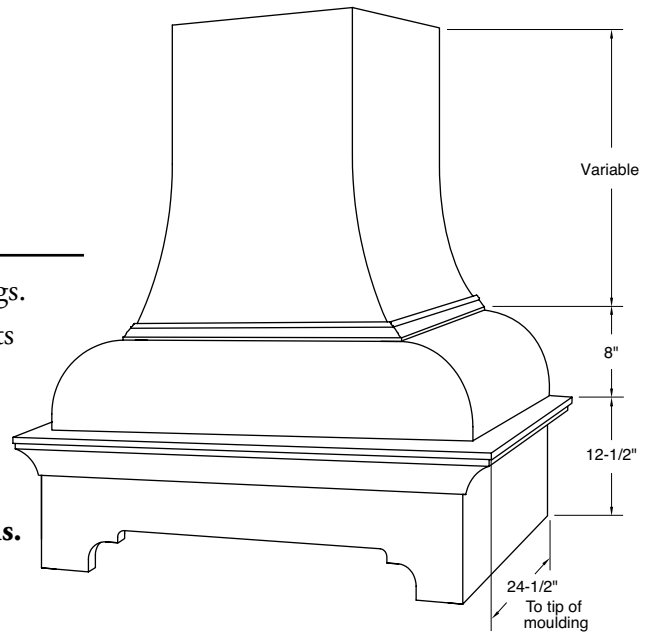
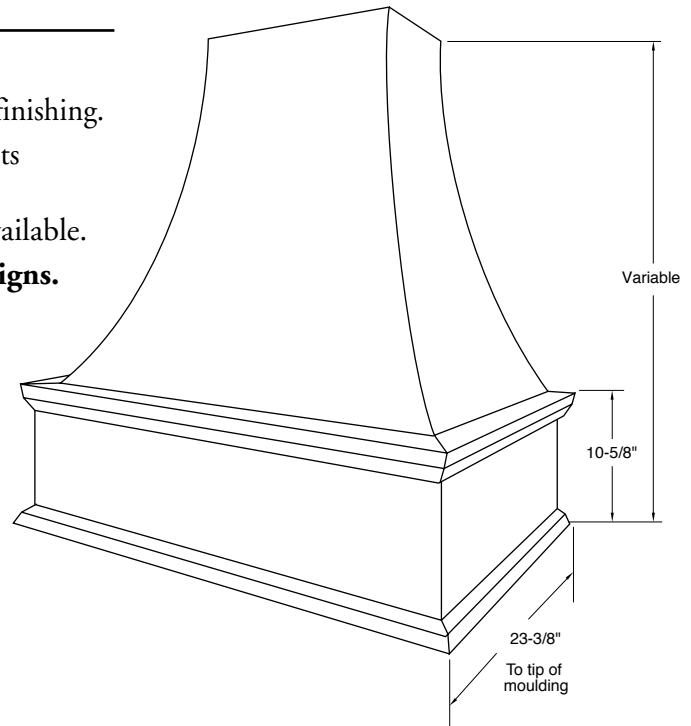

D-Decorative Panel Range Hood

- D-series is designed to best fit 8 to 10 foot ceilings.
- D-series hoods are not trimmable. Specific heights available through Special Designs.
- Lead-time 17 days unfinished, add 5-6 days for finishing.
- Removable panel not available.
- **Custom sizes available through Special Designs.**

Specie	Part Number											
	D-36x30	D-42x30	D-48x30	D-54x30	D-36x42	D-42x42	D-48x42	D-54x42	D-36x48	D-42x48	D-48x48	D-54x48
Alder	\$3,750	\$3,850	\$3,950	\$4,150	\$3,850	\$3,950	\$4,050	\$4,250	\$3,900	\$4,000	\$4,100	\$4,200
Cherry	3,750	3,850	3,950	4,150	3,850	3,950	4,050	4,250	3,900	4,000	4,100	4,200
Hard Maple	3,650	3,750	3,850	4,050	3,750	3,850	3,950	4,150	3,800	3,900	4,000	4,100
Red Oak	3,600	3,700	3,800	4,000	3,700	3,800	3,900	4,100	3,750	3,850	3,950	4,050

Add 4-1/2" to width listed in pricing chart for actual overall width including trim moulding.



Stanisci Design Range Hoods (continued)

I-Series (Four-sided Island Hood)

- I-Series hood is designed to provide ventilation above an island range.
- Overall height must be provided when ordering I-series.
- Prefinished hoods will be finished on all 4 sides.
- Includes installation hardware.
- Lead-time 12 days unfinished, add 5-6 days for finishing.
- Fixed panel standard - available with removable panel option.
- **Custom sizes available through Special Designs.**

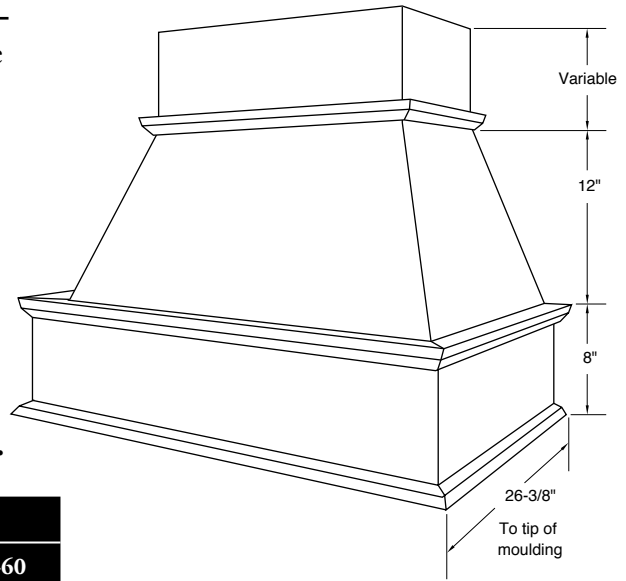

Specie	Part Number				
	I-36	I-42	I-48	I-54	I-60
Alder	\$2,025	\$2,100	\$2,175	\$2,635	\$2,715
Cherry	2,025	2,100	2,175	2,635	2,715
Hard Maple	1,975	2,050	2,100	2,550	2,640
Red Oak	1,880	1,950	2,000	2,460	2,525

Add 2-1/4" to width listed in pricing chart for actual overall width including trim moulding.

MTA Hood

- Features matching arches on top and bottom of panel.
- Profile options - Framing Bead: Regular, Ogee or Square.
Panel Raise: Slant, G-Cove, RM, M-Bead or P-057.
- Hood includes shelf, shipped unattached.
- Lead-time 17 days unfinished, add 5-6 days for finishing.
- Removable panel standard - must request fixed panel.
- **Custom sizes available through Special Designs.**

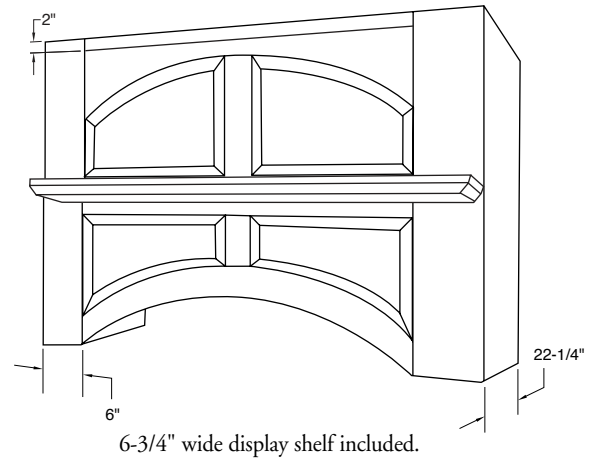

Specie	Part Number											
	MTA-36x30	MTA-42x30	MTA-48x30	MTA-54x30	MTA-36x36	MTA-42x36	MTA-48x36	MTA-54x36	MTA-36x42	MTA-42x42	MTA-48x42	MTA-54x42
Alder	\$1,480	\$1,530	\$1,590	\$1,765	\$1,490	\$1,540	\$1,600	\$1,775	\$1,505	\$1,555	\$1,615	\$1,790
Cherry	1,480	1,530	1,590	1,765	1,490	1,540	1,600	1,775	1,505	1,555	1,615	1,790
Hard Maple	1,450	1,455	1,515	1,690	1,415	1,465	1,525	1,700	1,430	1,480	1,540	1,715
Red Oak	1,350	1,355	1,415	1,590	1,315	1,365	1,425	1,600	1,330	1,380	1,440	1,615



Stanisci Design Range Hoods (continued)

M-Series w/Shelf

- Profile options - Framing Bead: Regular, Ogee or Square.
Panel Raise: Slant, G-Cove, RM, M-Bead or P-057.
- Will accommodate corbels up to 5-1/2" wide, 10-1/2" high and 6" deep under display shelf. See the Wood Accents and Ornament pages in the Legs, Corbels and Accents section or the Enkeboll supplement booklet.
- Hood includes display shelf, shipped unattached.
- Lead-time 17 days unfinished, add 5-6 days for finishing.
- Removable panel standard - must request fixed panel.
- **Custom sizes available through Special Designs.**

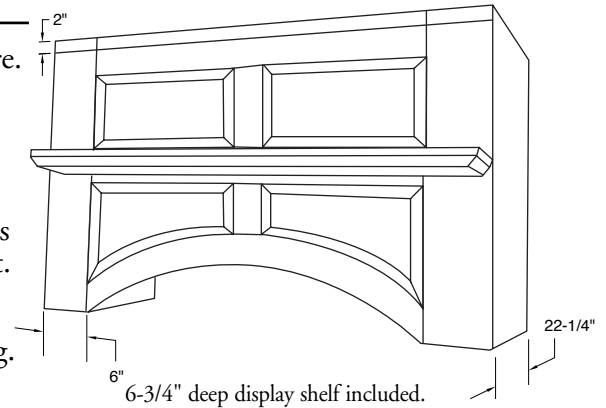

Part Number										
Specie	M-30x24	M-36x24	M-42x24	M-48x24	M-54x24	M-60x24	M-30x30	M-36x30	M-42x30	M-48x30
Alder	\$1,265	\$1,315	\$1,365	\$1,425	\$1,600	\$1,655	\$1,265	\$1,330	\$1,380	\$1,440
Cherry	1,265	1,315	1,365	1,425	1,600	1,655	1,265	1,330	1,380	1,440
Hard Maple	1,195	1,240	1,290	1,350	1,525	1,580	1,195	1,255	1,305	1,365
Red Oak	1,145	1,150	1,190	1,250	1,425	1,480	1,145	1,155	1,205	1,265
Specie	M-54x30	M-60x30	M-30x36	M-36x36	M-42x36	M-48x36	M-54x36	M-60x36	M-30x42	M-36x42
Alder	\$1,615	\$1,675	\$1,290	\$1,340	\$1,390	\$1,450	\$1,625	\$1,700	\$1,290	\$1,355
Cherry	1,615	1,675	1,290	1,340	1,390	1,450	1,625	1,700	1,290	1,355
Hard Maple	1,540	1,600	1,215	1,265	1,315	1,375	1,550	1,625	1,215	1,280
Red Oak	1,440	1,500	1,165	1,165	1,215	1,275	1,450	1,525	1,165	1,180
Specie	M-42x42	M-48x42	M-54x42	M-60x42						
Alder	\$1,405	\$1,465	\$1,640	\$1,725						
Cherry	1,405	1,465	1,640	1,725						
Hard Maple	1,330	1,390	1,565	1,650						
Red Oak	1,230	1,290	1,465	1,550						

SPECIALTY PRODUCTS

Custom Products

Stanisci Design Range Hoods (continued)

S-Series With Shelf

- Mantle style hood featuring incorporated display shelf.
- Profile options - Framing Bead: Regular, Ogee or Square. Panel Raise: Slant, G-Cove, RM, M-Bead or P-057.
- Display shelf depth is 6-1/8" deep.
- Lead-time 17 days unfinished, add 5-6 days for finishing.
- Removable panel standard – fixed panel not available.
- **Custom sizes available through Special Designs.**

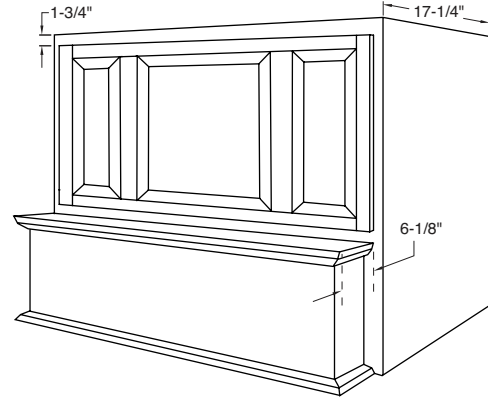

Part Number												
Specie	S-33x24	S-39x24	S-45x24	S-51x24	S-57x24	S-63x24	S-33x30	S-39x30	S-45x30	S-51x30	S-57x30	S-63x30
Alder	\$1,230	\$1,280	\$1,340	\$1,470	\$1,535	\$1,580	\$1,290	\$1,345	\$1,415	\$1,555	\$1,610	\$1,680
Cherry	1,230	1,280	1,340	1,470	1,535	1,580	1,290	1,345	1,415	1,555	1,610	1,680
Hard Maple	1,130	1,160	1,210	1,340	1,395	1,430	1,190	1,225	1,285	1,425	1,470	1,530
Red Oak	1,030	1,090	1,090	1,220	1,265	1,290	1,090	1,125	1,165	1,305	1,340	1,390
Specie	S-33x36	S-39x36	S-45x36	S-51x36	S-57x36	S-63x36	S-33x42	S-39x42	S-45x42	S-51x42	S-57x42	S-63x42
Alder	\$1,350	\$1,415	\$1,495	\$1,640	\$1,700	\$1,780	\$1,425	\$1,500	\$1,580	\$1,735	\$1,810	\$1,895
Cherry	1,350	1,415	1,495	1,640	1,700	1,780	1,425	1,500	1,580	1,735	1,810	1,895
Hard Maple	1,250	1,295	1,365	1,510	1,560	1,630	1,325	1,370	1,450	1,605	1,670	1,745
Red Oak	1,150	1,195	1,245	1,390	1,430	1,490	1,225	1,250	1,330	1,485	1,540	1,605

S-Raised Arch

- Profile Options - Framing Bead: Regular, Ogee or Square. Panel Raise: Slant, G-Cove, RM, M-Bead or P-057.
- Display shelf depth is 6-1/8" deep.
- Lead-time 17 days unfinished, add 5-6 days for finishing.
- Removable panel standard - fixed panel not available.
- **Custom sizes available through Special Designs.**

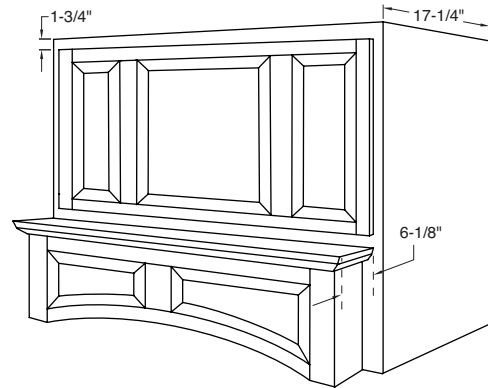

Part Number												
Specie	SRA-39x24	SRA-45x24	SRA-51x24	SRA-39x30	SRA-45x30	SRA-51x30	SRA-39x36	SRA-45x36	SRA-51x36	SRA-39x42	SRA-45x42	SRA-51x42
Alder	\$1,475	\$1,550	\$1,700	\$1,525	\$1,650	\$1,750	\$1,575	\$1,700	\$1,800	\$1,725	\$1,800	\$1,900
Cherry	1,475	1,550	1,700	1,525	1,650	1,750	1,575	1,700	1,800	1,725	1,800	1,900
Hard Maple	1,450	1,525	1,650	1,500	1,625	1,700	1,550	1,675	1,750	1,675	1,750	1,850
Red Oak	1,350	1,425	1,550	1,400	1,525	1,600	1,450	1,575	1,650	1,550	1,625	1,700



Stanisci Design Range Hoods (continued)

L-Series Range Hood

- Hearth style hood featuring incorporated display shelf.
- Profile Options - Framing Bead: Regular, Ogee or Square.
Panel Raise: Slant, G-Cove, RM,
M-Bead or P-057.
- Bead board is removable for easier installation of ventilation.
- Recess in the display niche is sized to fit 3" puck lights.
- Lead-time 17 days unfinished, add 5-6 days for finishing.
- Hood can accommodate corbels up to 9" wide, 12" high and 6" deep.
- Removable panel standard - must request fixed panel.
- **Custom sizes available through Special Designs.**

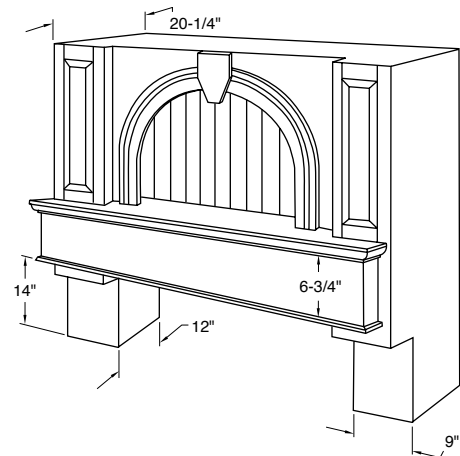

		Part Number								
Specie	L-54x44	L-60x44	L-66x44	L-54x50	L-60x50	L-66x50	L-54x56	L-60x56	L-66x56	
Alder	\$2,300	\$2,375	\$2,450	\$2,400	\$2,475	\$2,550	\$2,500	\$2,575	\$2,675	
Cherry	2,300	2,375	2,450	2,400	2,475	2,550	2,500	2,575	2,675	
Hard Maple	2,175	2,250	2,325	2,275	2,350	2,425	2,375	2,450	2,550	
Red Oak	2,025	2,200	2,175	2,125	2,200	2,275	2,225	2,300	2,400	

O-Series Range Hood

- Hearth style hood featuring incorporated display shelf.
- Profile Options - Framing Bead: Regular, Ogee or Square.
Panel Raise: Slant, G-Cove, RM,
M-Bead or P-057.
- Bead board is removable for easier installation of ventilation.
- Recess in the display niche is sized to fit 3" puck lights.
- 30" clearance between the bottom of the shelf and the bottom of the pillar.
- Spice rack pull-out option includes spice racks in right and left pillars: \$500
- Spice rack dimensions: 23" x 11".
- Lead-time 17 days unfinished, add 5-6 days for finishing.
- Removable panel standard - must request fixed panel.
- **Custom sizes available through Special Designs.**

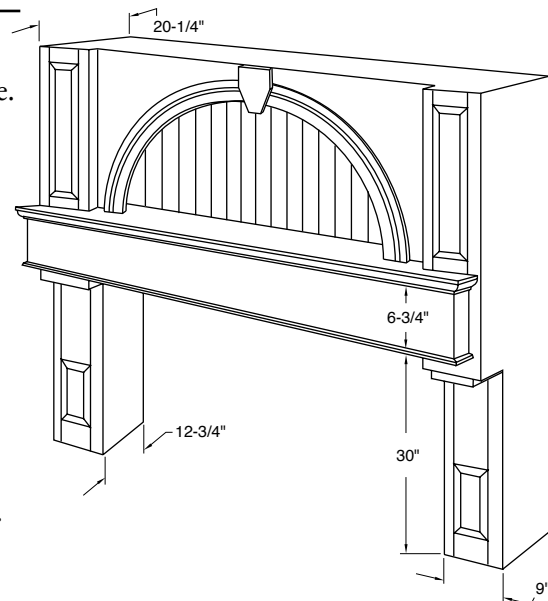

		Part Number											
Specie	O-60x60	O-72x60	O-84x60	O-90x60	O-66x72	O-72x72	O-84x72	O-90x72	O-66x84	O-72x84	O-84x84	O-90x84	
Alder	\$2,975	\$3,125	\$3,275	\$3,450	\$3,175	\$3,325	\$3,500	\$3,700	\$3,400	\$3,575	\$3,750	\$3,950	
Cherry	2,975	3,125	3,275	3,450	3,175	3,325	3,500	3,700	3,400	3,575	3,750	3,950	
Hard Maple	2,850	3,000	3,150	3,325	3,050	3,200	3,375	3,575	3,275	3,450	3,625	3,825	
Red Oak	2,700	2,850	3,000	3,175	2,900	3,050	3,225	3,425	3,125	3,300	3,475	3,675	

Stanisci Design Range Hoods (continued)

W-Raised Arch

- Profile options - Framing Bead: Regular, Ogee or Square.
Panel Raise: Slant, G-Cove, RM, M-Bead or P-057.
- Specify full panel or small panel pillars. Small panel pillars can accommodate corbels up to 9" wide, 12-7/8" high and 6" deep.
- 30" clearance between bottom of pillar and bottom of arched panel.
- Display shelf depth is 7-1/4" deep.
- Ships in four pieces, ready to assemble.
- Spice Rack Pull Out option includes racks in both left and right pillars; \$500 upcharge applies.
- Spice rack dimensions: 23" high x 11" wide.
- Lead-time 17 days unfinished, add 5-6 days for finishing.
- Removable panel standard - must request fixed panel.
- **Custom sizes available through Special Designs.**

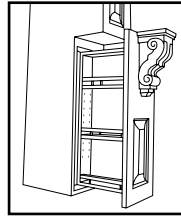

Spice Rack Option
(Corbel not included)

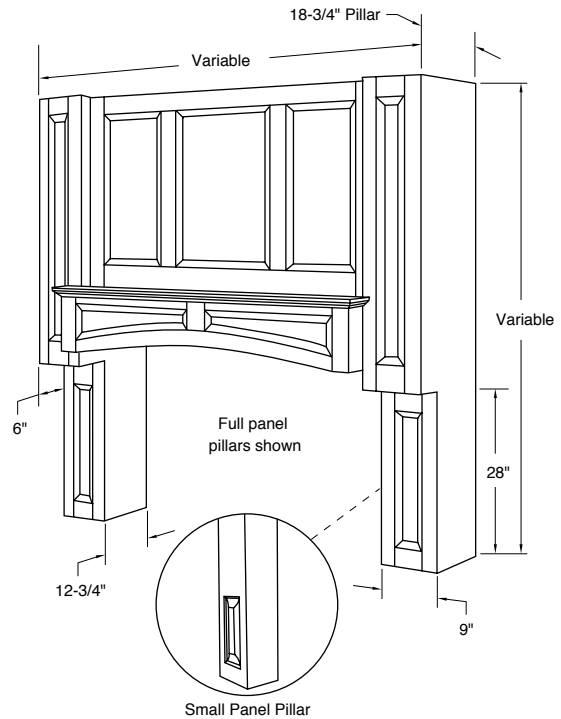

Small Panel Pillar

Part Number												
Specie	WRA-66x60	WRA-72x60	WRA-84x60	WRA-90x60	WRA-66x72	WRA-72x72	WRA-84x72	WRA-90x72	WRA-66x84	WRA-72x84	WRA-84x84	WRA-90x84
Alder	\$2,530	\$2,680	\$2,850	\$3,005	\$2,725	\$2,875	\$3,050	\$3,245	\$3,000	\$3,150	\$3,260	\$3,500
Cherry	2,530	2,680	2,850	3,005	2,725	2,875	3,050	3,245	3,000	3,150	3,260	3,500
Hard Maple	2,410	2,555	2,715	2,880	2,605	2,750	2,925	3,165	2,830	2,975	3,195	3,425
Red Oak	2,270	2,380	2,515	2,680	2,440	2,550	2,725	2,965	2,665	2,775	2,995	3,225

SPECIALTY PRODUCTS

Custom Products



Stanisci Design Range Hoods (continued)

H-Series Range Hood

- Hearth style hood featuring incorporated display shelf.
- Profile options - Framing Bead: Regular, Ogee or Square. Panel Raise: Slant, G-Cove, RM, M-Bead or P-057.
- Display shelf depth is 8-1/8" to tip of moulding.
- 54" and 60" wide hoods – have two panels on top wainscot.
- 66" wide hoods – have three panels on top wainscot.
- Lead-time 17 days unfinished, add 5-6 days for finishing.
- Removable panel standard – must request fixed panel.
- **Custom sizes available through Special Designs.**

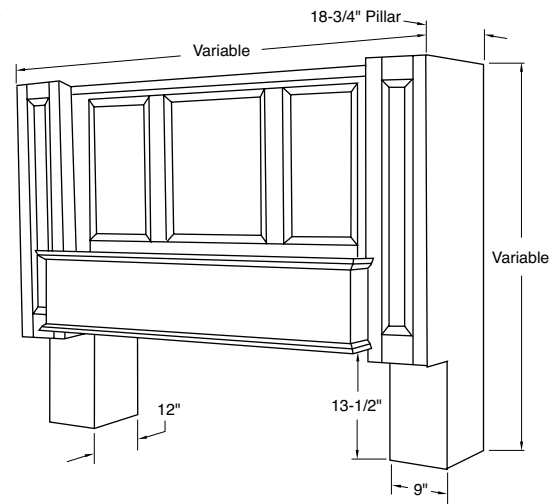

Part Number									
Specie	H-54x44	H-60x44	H-66x44	H-54x50	H-60x50	H-66x50	H-54x56	H-60x56	H-66x56
Alder	\$1,960	\$2,045	\$2,130	\$2,055	\$2,140	\$2,240	\$2,155	\$2,255	\$2,355
Cherry	1,960	2,045	2,130	2,055	2,140	2,240	2,155	2,255	2,355
Hard Maple	1,870	1,955	2,040	1,965	2,050	2,140	2,065	2,155	2,255
Red Oak	1,785	1,870	1,955	1,880	1,965	2,055	1,980	2,070	2,170

H-Raised Arch Range Hood

- Hearth style hood featuring incorporated display shelf.
- Profile options - Framing Bead: Regular, Ogee or Square. Panel Raise: Slant, G-Cove, RM, M-Bead or P-057.
- Display shelf depth is 8-1/8" to tip of moulding.
- 54" and 60" wide hoods – have two panels on top wainscot.
- 66" wide hoods – have three panels on top wainscot.
- Lead-time 17 days unfinished, add 5-6 days for finishing.
- Removable panel standard – must request fixed panel.
- **Custom sizes available through Special Designs.**

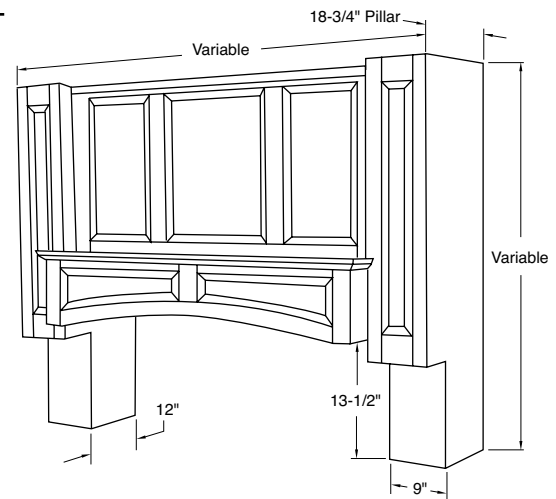

Part Number									
Specie	HRA-54x44	HRA-60x44	HRA-66x44	HRA-54x50	HRA-60x50	HRA-66x50	HRA-54x56	HRA-60x56	HRA-66x56
Alder	\$2,150	\$2,235	\$2,320	\$2,240	\$2,330	\$2,425	\$2,345	\$2,445	\$2,545
Cherry	2,150	2,235	2,320	2,240	2,330	2,425	2,345	2,445	2,545
Hard Maple	2,060	2,145	2,230	2,150	2,240	2,330	2,255	2,345	2,445
Red Oak	1,975	2,060	2,145	2,065	2,155	2,245	2,170	2,260	2,360

Stanisci Design Range Hoods (continued)

Q-Standard Range Hood

- Valance/mantle style hood is designed to be mounted between left and right cabinets.
- Profile Options - Framing Bead: Regular, Ogee or Square. Panel Raise: Slant, G-Cove, RM, M-Bead or P-057.
- Hood includes shelf and shelf supports, shipped attached.
- Lead-time 17 days unfinished, add 5-6 days for finishing.
- Removable panel standard - must request fixed panel.
- **Custom sizes available through Special Designs.**

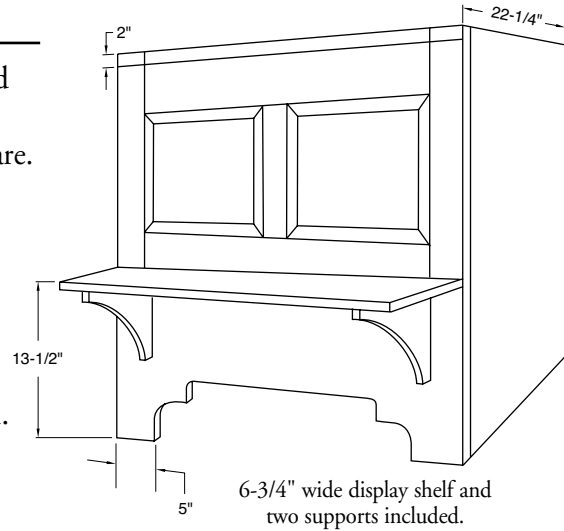

Specie	Part Number											
	Q-36x24	Q-42x24	Q-36x30	Q-42x30	Q-48x30	Q-36x36	Q-42x36	Q-48x36	Q-36x42	Q-42x42	Q-48x42	Q-54x42
Alder	\$1,355	\$1,405	\$1,420	\$1,470	\$1,520	\$1,400	\$1,450	\$1,500	\$1,400	\$1,450	\$1,500	\$1,550
Cherry	1,355	1,405	1,420	1,470	1,520	1,400	1,450	1,500	1,400	1,450	1,500	1,550
Hard Maple	1,265	1,315	1,330	1,380	1,430	1,310	1,360	1,410	1,310	1,360	1,410	1,460
Red Oak	1,215	1,265	1,280	1,330	1,380	1,260	1,310	1,360	1,260	1,310	1,360	1,410

J-Raised Arch

- J-Raised Arch is designed to be mounted between left and right cabinets.
- Hood can be sized to best fit 8 or 9 foot ceilings.
- Profile Options - Framing Bead: Regular, Ogee or Square. Panel Raise: Slant, G-Cove, RM, M-Bead or P-057.
- Lead-time 17 days unfinished, add 5-6 days for finishing.
- Fixed panel standard - must request removable panel option.
- **Custom sizes available through Special Designs.**

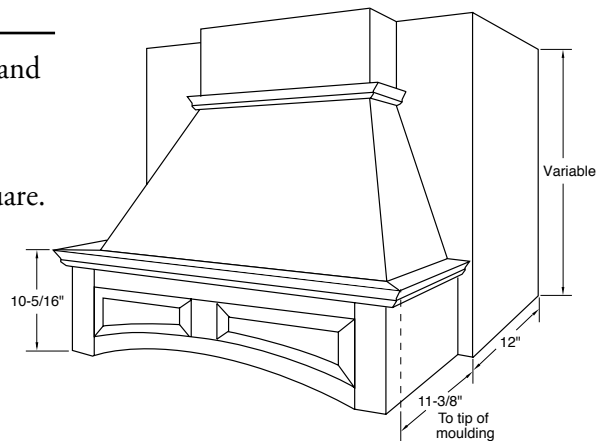

Specie	Part Number											
	JRA-33x30	JRA-39x30	JRA-45x30	JRA-51x30	JRA-57x30	JRA-63x30	JRA-33x36	JRA-39x36	JRA-45x36	JRA-51x36	JRA-57x36	JRA-63x36
Alder	\$1,385	\$1,425	\$1,475	\$1,750	\$1,950	\$2,150	\$1,385	\$1,435	\$1,485	\$1,785	\$1,985	\$2,085
Cherry	1,385	1,425	1,475	1,750	1,950	2,150	1,385	1,435	1,485	1,785	1,985	2,085
Hard Maple	1,285	1,325	1,375	1,650	1,850	2,050	1,285	1,335	1,385	1,685	1,885	1,985
Red Oak	1,185	1,225	1,275	1,550	1,750	1,950	1,185	1,235	1,285	1,585	1,785	1,885



Stanisci Design Range Hoods (continued)

VCHIM Series Range Hood – Straight Valance

- Stylish straight valance complements traditional or contemporary designs.
- Designed to fit up to a 9 foot ceiling.
- Plywood chimney and upper, solid wood apron.
- 18" chimney can be trimmed to desired height and is shipped separately.
- Lead-time 7 days unfinished, add 5-6 days for finishing.
- Fixed panel standard – removable panel not available.
- Ventilators available through Stanisci Design with special Conestoga discount.
- **Custom sizes not available.**

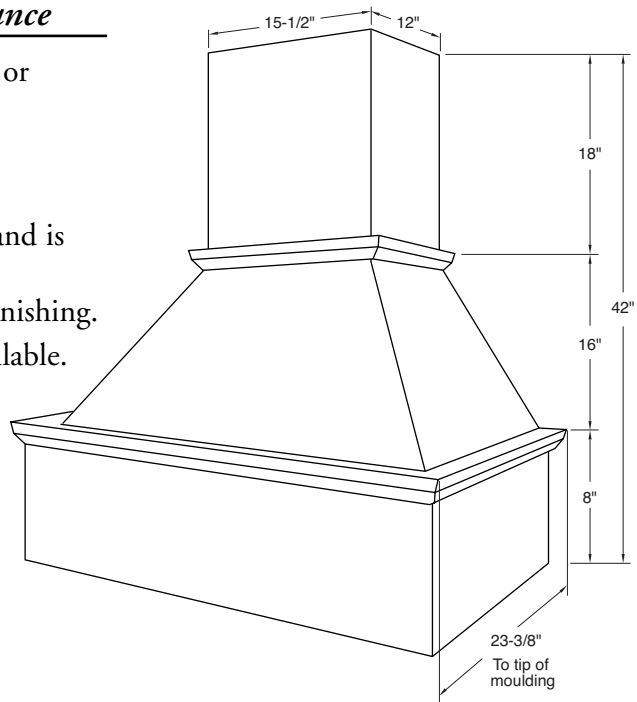

Specie	Part Number			
	SV-30x42	SV-36x42	SV-42x42	SV-48x42
Alder	\$760	\$810	\$875	\$910
Cherry	760	810	875	910
Hard Maple	715	765	825	860
Red Oak	715	765	825	860

Add 2-1/4" to width listed in pricing chart for actual overall width including trim moulding.

VCHIM Series Range Hood – Arched Valance

- Stylish arched valance complements traditional designs.
- Designed to fit up to a 9 foot ceiling.
- Plywood chimney and upper, solid wood apron.
- 18" chimney can be trimmed to desired height and is shipped separately.
- Lead-time 7 days unfinished, add 5-6 days for finishing.
- Fixed panel standard – removable panel not available.
- Ventilators available through Stanisci Design with special Conestoga discount.
- **Custom sizes not available.**

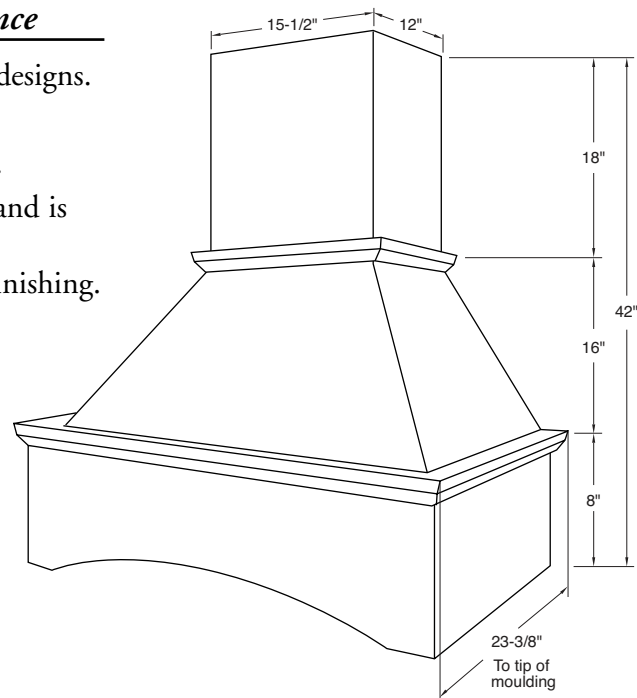

Specie	Part Number			
	AV-30x42	AV-36x42	AV-42x42	AV-48x42
Alder	\$800	\$840	\$890	\$925
Cherry	800	840	890	925
Hard Maple	750	790	835	865
Red Oak	750	790	835	865

Add 2-1/4" to width listed in pricing chart for actual overall width including trim moulding.



Notes